

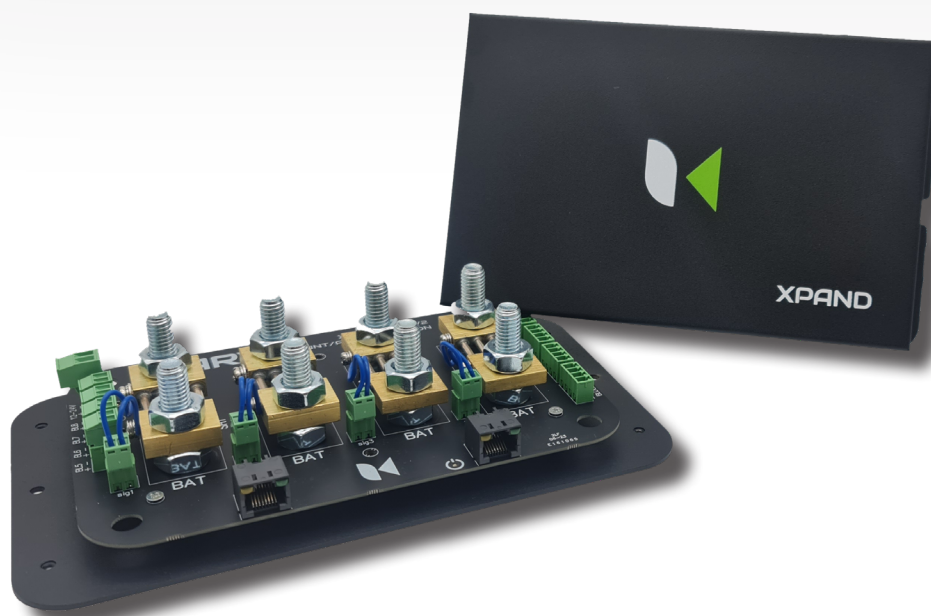

XPAND ARVISHUNT DATASHEET



XPAND ARVISHUNT DATASHEET

XPAND ArviShunt is an expansion to the core Smart Caravaning™ Control Systems for RV and Marine. It connects to it's electroblock ArviCore to provide a solution when it is necessary to manage devices with currents above 30/40 A or 300 W.

PRODUCT DESCRIPTION:

XPAND Arvishunt is a versatile 4-in-1 power management solution specifically designed for RVs. This powerful solution can handle up to 1200A across four shunts and offers four (4) unique modes to cater to a variety of power management needs: Power Manager, Battery Manager, Shunt Manager, and Multi Manager Mode.

FEATURES:

- Contains 4x shunts capable of handling currents between 300-400A (4800w) per shunt
- 4 different modes to choose from for additional control over high-current devices
- Monitor temperature of each of the shunts via built-in temperature sensors
- Relay outputs for added control, protection and emergency shutdown
- Compatible with Smart Caravaning™ System

POWER MANAGER MODE:

This mode allows for complete control of high-current devices, including inverters (up to 4,800W or 400A), battery chargers (up to 4,800W or 400A), DC-DC chargers/boosters (up to 300A), and solar regulators (up to 300A).

BATTERY MANAGER MODE:

Designed to manage and monitor up to four different types of batteries, including lithium, this mode offers comprehensive diagnostics such as SOH (State of Health), SOC (State of Charge), accumulated charge cycles, and temperature readings from eight separate probes (internal and shunt). Batteries can be automatically disconnected based on user-defined parameters, and full data and equalization graphs are displayed on the screen for enhanced user insights.

SHUNT MANAGER MODE:

This mode focuses on controlling and monitoring up to four non-specific power devices, such as air conditioning systems and motors, with a capacity of 2x400A + 2x300A. Shunt Manager provides independent protection for each device based on current, power, and temperature limits, ensuring optimal performance and safety.

MULTI MANAGER MODE:

For users seeking a more integrated approach to power management, the Multi Manager mode allows simultaneous management of up to 2x Shunts and up to 2x Batteries. This mode combines the functionality of both Battery Manager and Shunt Manager modes, providing a streamlined solution for monitoring and controlling multiple devices at once.

INTEGRATED TEMPERATURE SENSORS:

Each shunt is equipped with an integrated temperature sensor, allowing the system to send alerts or shut down loads when set levels are exceeded.

RELAY OUTPUT CONTROL:

Each shunt is controlled by a relay output, enabling on-demand cut (via display) or automatic cut for security reasons or during Smart Mode™ operation. Additionally, Relay outputs can also be utilized to activate Remote inputs of corresponding equipment.

PART NUMBERS:

OPERATING	Content	SKU	EAN
XPAND ARVISHUNT	Multipurpose power control with 4x shunts	ARV000XSHUNT2	7427252113662

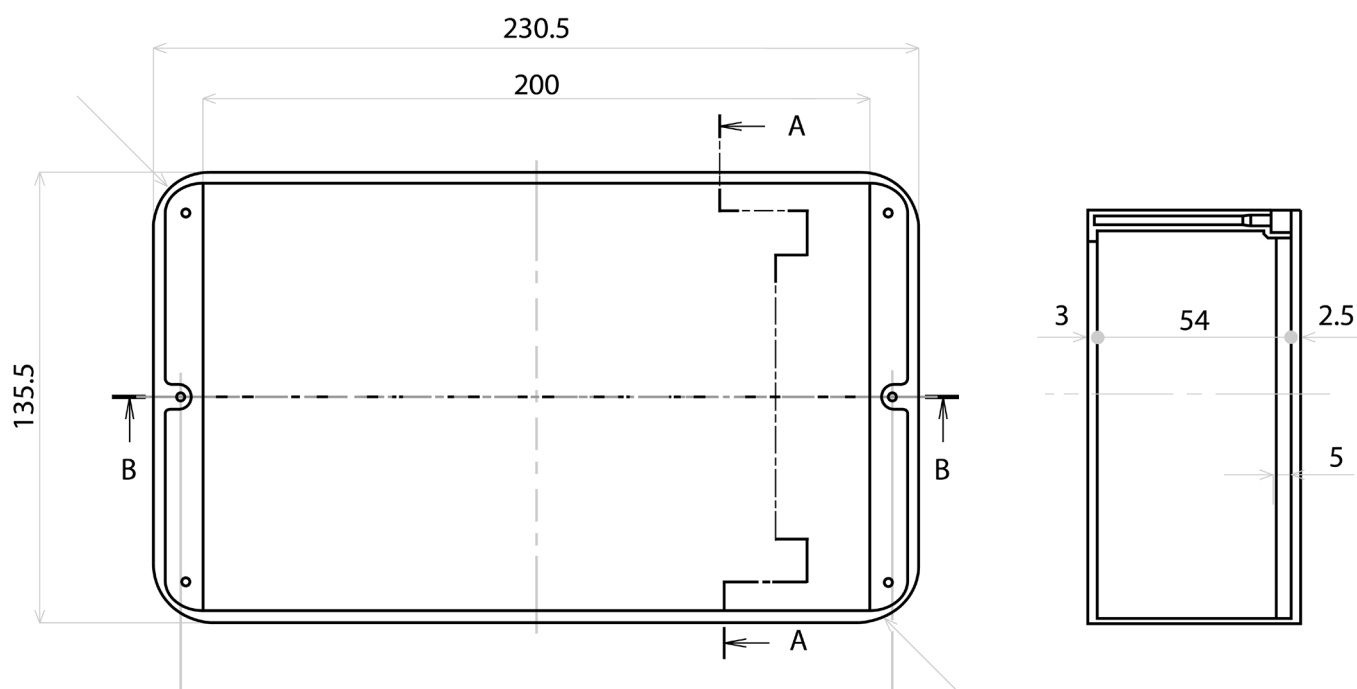

SPECIFICATIONS

OPERATING	
No. of Shunts	4
Power Source Voltage Range	6 - 24V
Operating/Storage Temperature	-20°C to +50°C / -20°C to +70°C
Operating Humidity	40% – 50%
Power consumption at 12V	3mA
Current measuring channels	4
Max Operating Current	1A
Max Common Input Voltage	6 – 24V
VOLTAGE INPUTS	
	• 222.72mm (W) x 125.28mm (H)
Per channel	0,01 – 400A
Resolution	0.01A
Accuracy	± 0.5%
Sampling rate	130ms
MAX CURRENT	
Continuous	400A
Peak current	480A (2h)
Voltage drop (at 400A)	75mV
CONNECTIVITY	
Current Sensors	4 (Voltage, Current, Temperature)
Relay Common Input (COM) 1	1
12V Output for Relay	4
ARVIBUS CAN	2
SiCOM RJ9 Sockets	2
CERTIFICATION	
Certification	RoHS
DIMENSIONS	
Dimensions	230 X 135 X 60 mm (L/W/H) including fixings
Weight	– < 1Kg

RELATED PRODUCTS:

ArviShunt is part of the Smart Caravaning Control System.
Please refer to other related products.



ArviCore

ARVICORE is our next gen electrobock, at the core of the smart caravaning™ control system for recreational vehicles and marine.



Arviev display Standard 7" 10" & 15"

ARVIVIEW displays: Stunning visuals, reliable performance, and convenient access to your vehicle via the Smart Caravaning™ App.



Arviev display OEM 7" & OEM 10"

The ARVIVIEW OEM display is purpose-built for OEM partners, featuring a sleek design, superior performance, and customization options. With crystal-clear visuals, powerful processing, and seamless integration with ARVIKON's Smart Caravaning system, it provides the ultimate convenience and ease of use.





CIVD
Caravaning Industrie Verband e.V.
MEMBERS



**Deutsches
Patent- und Markenamt**

Die Präsidentin des Deutschen Patent- und Markenamts

Christine R. Schöf-Schäfer



Oficina Española
de Patentes y Marcas

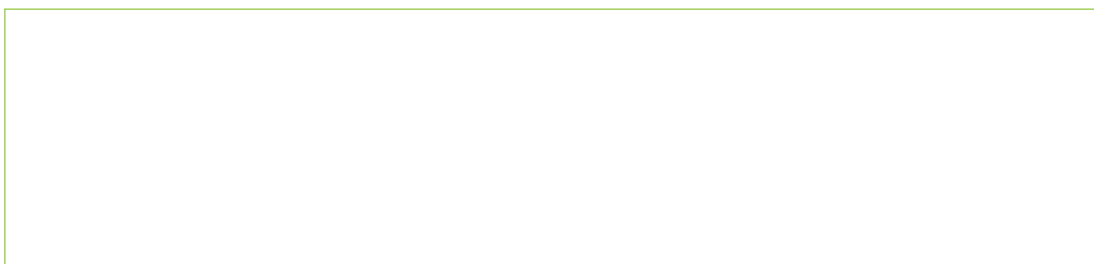

WWW.ARVIKON.COM